

POINT LAWRENCE ROAD CULVERT REPLACEMENT

ENGINEER'S SUGGESTED TEMPORARY TRAFFIC CONTROL PLAN

ORCAS ISLAND - SAN JUAN COUNTY

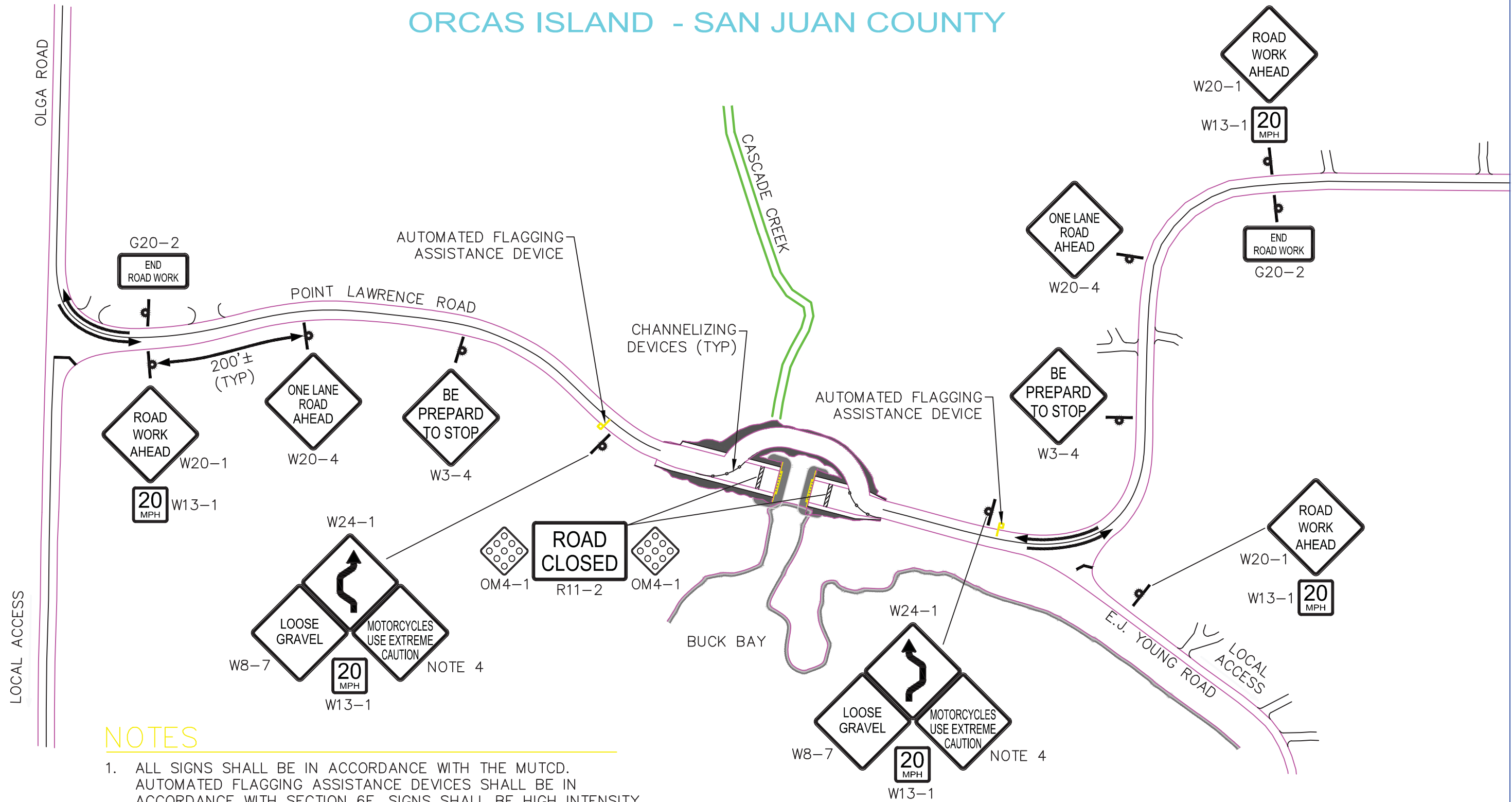

NOTES

1. ALL SIGNS SHALL BE IN ACCORDANCE WITH THE MUTCD. AUTOMATED FLAGGING ASSISTANCE DEVICES SHALL BE IN ACCORDANCE WITH SECTION 6E. SIGNS SHALL BE HIGH INTENSITY PRISMATIC.
2. ALL SIGNS SHALL BE PLACED 5 FEET FROM THE EDGE OF PAVEMENT. THE BOTTOM OF THE SIGNS SHALL BE 4 FEET ABOVE THE GROUND.
3. ROAD CLOSED SIGNS SHALL BE PLACED ON BARRICADES PER WSDOT STD. PLAN K-80.20-00.
4. MOTORCYCLES USE EXTREME CAUTION SIGN PER WAC 468-95-306.

V:\ROADS\595 CONSTRUCTION\2011\020506 POINT LAWRENCE ROAD CULVERT REPLACEMENT (MP 0.2)\DRAWINGS AND MAPS\C3D\020506 Traffic Control Plan.dwg 2011-2-10

 Public Works Department San Juan County	ORCAS ISLAND CRP No. 020506 ROAD No. 63 MILE POST 0.37
	915 Spring St. P.O. Box 729 • (360) 370-0500 Friday Harbor, WA 98250 • Fax (360) 378-6405 www.co.san-juan.wa.us/publicworks email: publicwks@sjcpublicworks.org